



## FLANGED STUDDED CROSSES AND TEES (AS PER API-6A)

\*All dimensions are in inches.

(1-1) PRESSURE RATING:- 2000 PSI			
NOMINAL SIZE & BORE		CENTER TO FACE	
Ød1 (VERTICAL)	Ød2 (OUTLET)	H2 (VERTICAL)	H1 (HORIZONTAL)
2 1/16	2 1/16	3.50	3.50
2 9/16	2 1/16	3.50	4.00
2 9/16	2 9/16	4.50	4.50
3 1/8	2 1/16	3.50	4.50
3 1/8	2 9/16	4.50	4.50
3 1/8	3 1/8	4.50	4.50
4 1/16	2 1/16	4.50	5.50
4 1/16	2 9/16	4.50	5.50
4 1/16	3 1/8	4.50	5.50
4 1/16	4 1/16	5.50	5.50

(1-2) PRESSURE RATING:- 3000 PSI			
NOMINAL SIZE & BORE		CENTER TO FACE	
Ød1 (VERTICAL)	Ød2 (OUTLET)	H2 (VERTICAL)	H1 (HORIZONTAL)
3 1/8	2 1/16	4.50	5.00
3 1/8	2 9/16	5.00	5.00
3 1/8	3 1/8	5.00	5.00
4 1/16	2 1/16	4.50	6.12
4 1/16	2 9/16	5.00	6.12
4 1/16	3 1/8	5.00	6.12
4 1/16	4 1/16	6.12	6.12

(1-3) PRESSURE RATING:- 5000 PSI			
NOMINAL SIZE & BORE		CENTER TO FACE	
Ød1 (VERTICAL)	Ød2 (OUTLET)	H2 (VERTICAL)	H1 (HORIZONTAL)
2 1/16	2 1/16	4.50	4.50
2 9/16	2 1/16	4.50	5.00
2 9/16	2 9/16	5.00	5.00
3 1/8	2 1/16	4.50	5.50
3 1/8	2 9/16	5.50	5.50
3 1/8	3 1/8	5.50	5.50
4 1/16	2 1/16	4.50	6.50
4 1/16	2 9/16	5.00	6.50
4 1/16	3 1/8	5.50	6.50
4 1/16	4 1/16	6.50	6.50

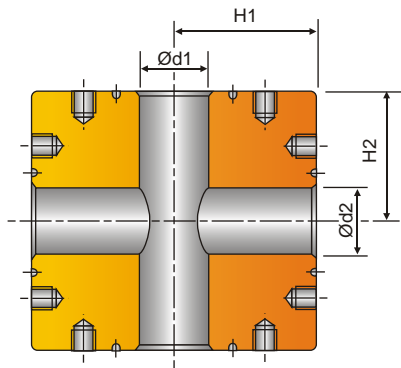

API Studded Tee

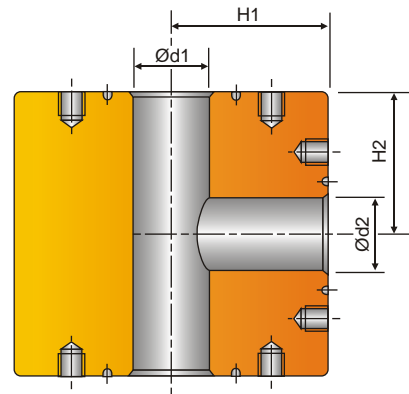

API Studded Cross

(1-4) PRESSURE RATING:- 10000 PSI			
NOMINAL SIZE & BORE		CENTER TO FACE	
Ød1 (VERTICAL)	Ød2 (OUTLET)	H2 (VERTICAL)	H1 (HORIZONTAL)
1 13/16	1 13/16	4.38	4.38
2 1/16	1 13/16	4.38	4.38
2 1/16	2 1/16	4.38	4.38
2 9/16	1 13/16	4.50	5.12
2 9/16	2 1/16	4.50	5.12
2 9/16	2 9/16	5.12	5.12
3 1/16	1 13/16	4.50	5.88
3 1/16	2 1/16	4.50	5.88
3 1/16	2 9/16	5.12	5.88
3 1/16	3 1/16	5.88	5.88
4 1/16	1 13/16	4.50	6.88
4 1/16	2 1/16	4.50	6.88
4 1/16	2 9/16	5.12	6.88
4 1/16	3 1/16	5.88	6.88
4 1/16	4 1/16	6.88	6.88

(1-5) PRESSURE RATING:- 15000 PSI			
NOMINAL SIZE & BORE		CENTER TO FACE	
Ød1 (VERTICAL)	Ød2 (OUTLET)	H2 (VERTICAL)	H1 (HORIZONTAL)
1 13/16	1 13/16	5.00	5.00
2 1/16	1 13/16	5.00	5.00
2 1/16	2 1/16	5.00	5.00
2 9/16	1 13/16	5.50	5.50
2 9/16	2 1/16	5.50	5.50
2 9/16	2 9/16	5.50	5.50
3 1/16	1 13/16	6.31	6.31
3 1/16	2 1/16	6.31	6.31
3 1/16	2 9/16	6.31	6.31
3 1/16	3 1/16	6.31	6.31
4 1/16	1 13/16	7.62	7.62
4 1/16	2 1/16	7.62	7.62
4 1/16	2 9/16	7.62	7.62
4 1/16	3 1/16	7.62	7.62
4 1/16	4 1/16	7.62	7.62

(1-6) PRESSURE RATING:- 20000 PSI			
NOMINAL SIZE & BORE		CENTER TO FACE	
Ød1 (VERTICAL)	Ød2 (OUTLET)	H2 (VERTICAL)	H1 (HORIZONTAL)
1 13/16	1 13/16	6.47	6.47
2 1/16	1 13/16	6.47	6.47
2 1/16	2 1/16	6.47	6.47
2 9/16	1 13/16	7.28	7.28
2 9/16	2 1/16	7.28	7.28
2 9/16	2 9/16	7.28	7.28
3 1/16	1 13/16	7.97	7.97
3 1/16	2 1/16	7.97	7.97
3 1/16	2 9/16	7.97	7.97
3 1/16	3 1/16	7.97	7.97
4 1/16	1 13/16	9.91	9.91
4 1/16	2 1/16	9.91	9.91
4 1/16	2 9/16	9.91	9.91
4 1/16	3 1/16	9.91	9.91
4 1/16	4 1/16	9.91	9.91