



LIFT SUBS & LIFT PLUGS

A) LIFT PLUGS

PARVEEN manufactures lifts plugs to suit various sizes O.D. drill collars. Bottom portion is threaded, the center section is bored to reduce weight. Manufactured from materials & heat treated to drill collar specifications.

B) LIFT SUBS

PARVEEN lifts subs are manufactured from standard heat treated drill collar material specifications as per following sizes & figure.

To order or request quotations on Parveen Lift Plugs, Please Specify:

1. Drill Collar O.D.
2. Drill collar connection size and Type.
3. Bore diameter, if required.

To order or request quotations on Parveen Lift Subs, Please Specify:

1. Drill Collar O.D.
2. Tool Joint O.D.
3. Tapered or square shoulder
4. Drill pipe O.D.
5. Drill collar connection size and Type.
6. Bore diameter, if required.
7. Pressed or cast steel thread protectors.

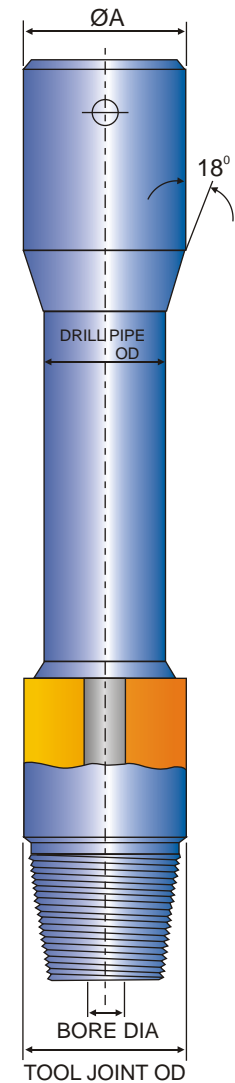

Lift Sub

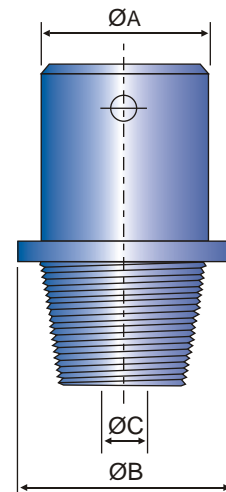

Lift Plug

LIFT PLUG DIMENSIONS			
DRILL COLLAR SIZE (A'')	LIFING PLATE DIA (B'')	CONN. BORE (C'')	APPROX. WEIGHT (lbs)
3.1/2	5.1/2	1.1/2	35
4.1/8	6	2	40
4.3/4	6.1/2	2.1/4	50
5	7	2.1/4	58
6	8	2.1/4	82
6.1/4	8	2.1/4	82
6.1/2	8.1/2	2.1/4	90
6.3/4	8.1/2	2.1/4	90
7	9	2.13/16	100
7.1/4	9	2.13/16	100
8	10	2.13/16	128
8.1/4	10	2.13/16	128
9.1/2	11.1/2	2.13/16	165
9.3/4	11.1/2	2.13/16	165
11	13	2.13/16	245

LIFT SUB DIMENSIONS	
TOOL JOINT O.D (A'')	APPROX. WEIGHT (lbs)
3.1/2	40
4.1/8	50
4.3/4	84
5	88
6	150
6.1/4	168
6.1/2	168
6.3/4	168
7	169
7.1/4	169
8	257
8.1/4	257
9.1/2	320
9.3/4	320
11	368